

Priority of Fire-Rated Partition Walls

PRIORITY OF PARTITIONS

THE "PRIORITY" OF PARTITIONS OF DIFFERENT TYPES IS DETERMINED AS FOLLOWS:

1. FIRE RATED PARTITIONS HAVE PRIORITY OVER NON-RATED PARTITIONS.
2. PARTITIONS WITH GREATER FIRE RATINGS HAVE PRIORITY OVER PARTITIONS WITH LESSER FIRE RATINGS. EXAMPLE: TWO-HOUR RATED PARTITIONS HAVE PRIORITY OVER ONE-HOUR FIRE RATED PARTITIONS.
3. SMOKE-SEALED PARTITIONS HAVE PRIORITY OVER NON-SMOKE SEALED PARTITIONS OF SIMILAR RATING. REFER TO ADDITIONAL COMPONENTS MATRIX FOR REQUIREMENTS.

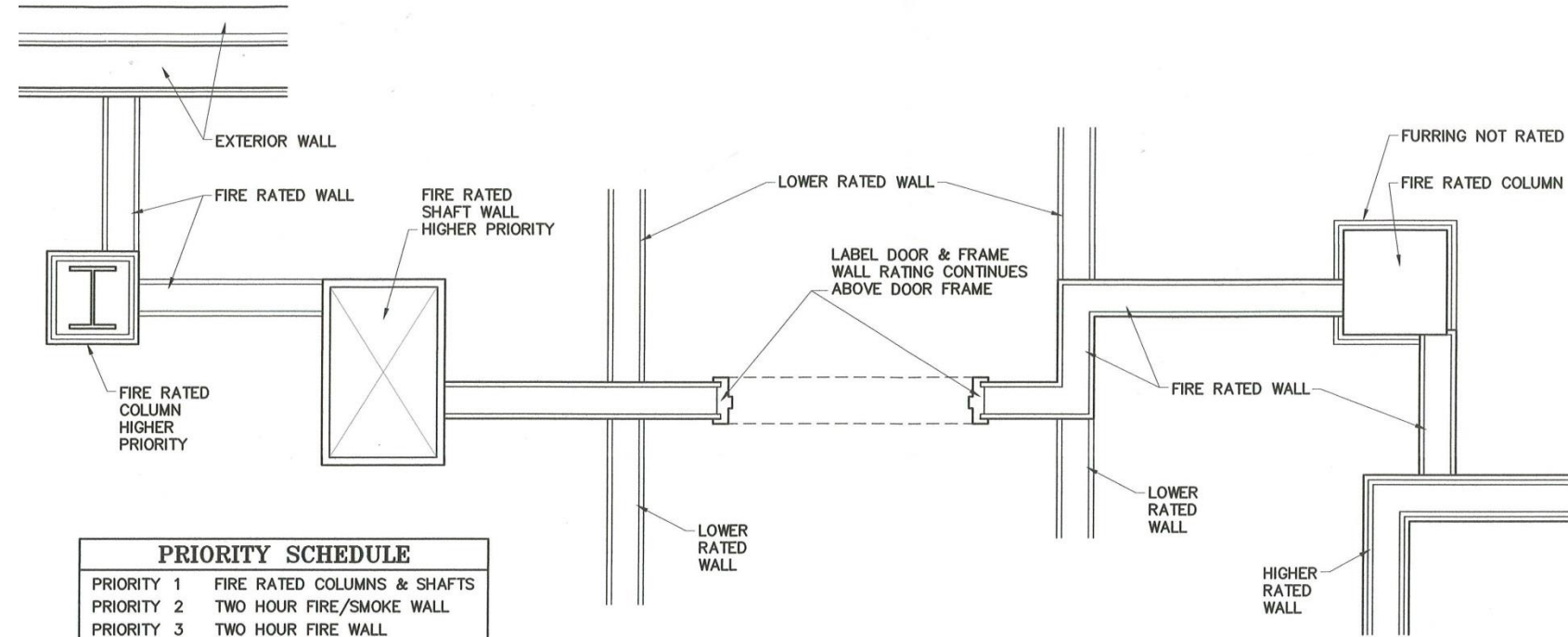

PRIORITY SCHEDULE	
PRIORITY 1	FIRE RATED COLUMNS & SHAFTS
PRIORITY 2	TWO HOUR FIRE/SMOKE WALL
PRIORITY 3	TWO HOUR FIRE WALL
PRIORITY 4	ONE HOUR FIRE/SMOKE WALL
PRIORITY 5	ONE HOUR FIRE WALL
PRIORITY 6	SMOKE WALL
PRIORITY 7	ACOUSTICAL WALL
PRIORITY 8	NON-RATED PARTITION

PRIORITY DETAILS

NOT TO SCALE

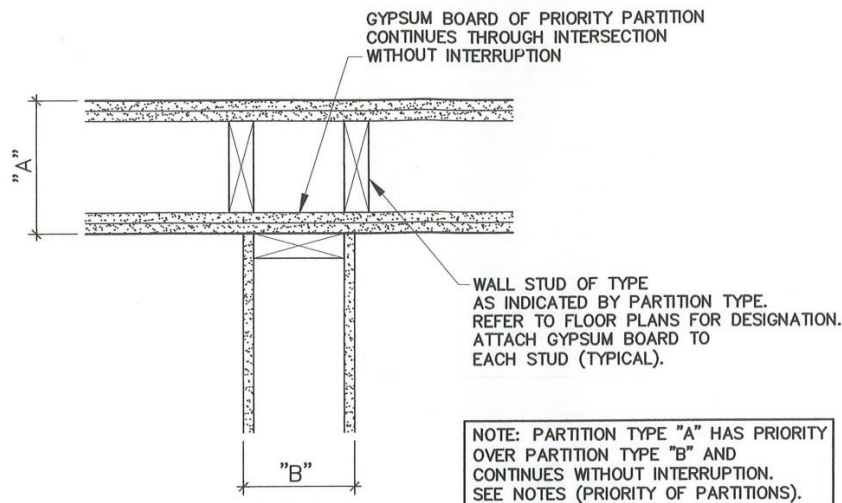

THREE-WAY INTERSECTION

NOTE: PARTITION TYPE "A" HAS PRIORITY OVER PARTITION TYPE "B" AND CONTINUES WITHOUT INTERRUPTION. SEE NOTES (PRIORITY OF PARTITIONS).

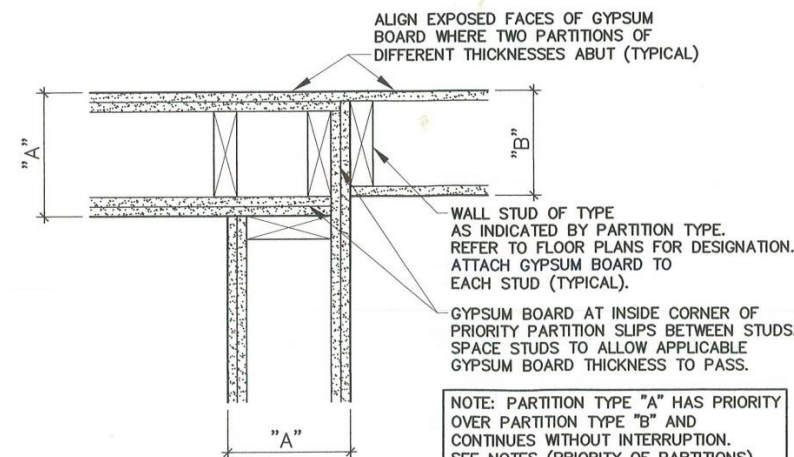

THREE-WAY INTERSECTION

NOTE: PARTITION TYPE "A" HAS PRIORITY OVER PARTITION TYPE "B" AND CONTINUES WITHOUT INTERRUPTION. SEE NOTES (PRIORITY OF PARTITIONS).

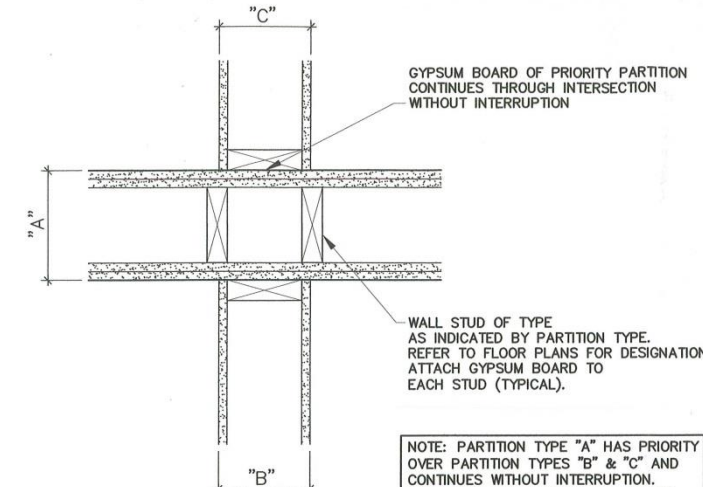

FOUR-WAY INTERSECTION

NOTE: PARTITION TYPE "A" HAS PRIORITY OVER PARTITION TYPES "B" & "C" AND CONTINUES WITHOUT INTERRUPTION. SEE NOTES (PRIORITY OF PARTITIONS).

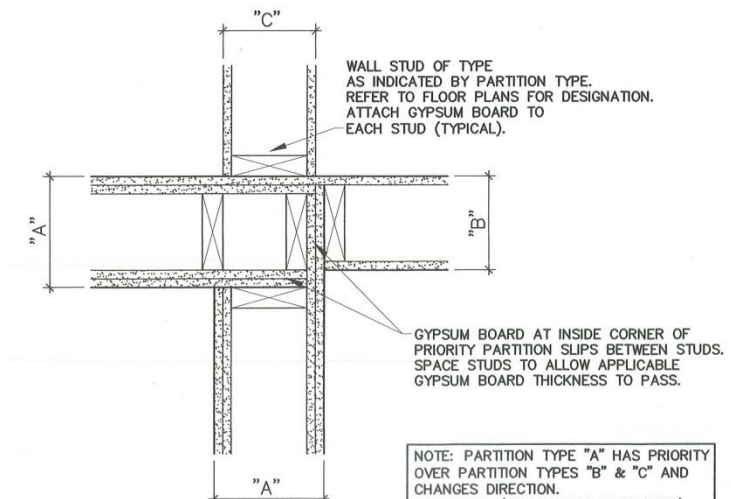

FOUR-WAY INTERSECTION

NOTE: PARTITION TYPE "A" HAS PRIORITY OVER PARTITION TYPES "B" & "C" AND CHANGES DIRECTION. SEE NOTES (PRIORITY OF PARTITIONS).